

HSV08-31

二位三通电磁阀 滑阀型

Three-Way, Two-Position, Spool-Type Cartridge Solenoid Valve

OPERATION

工作原理

When de-energized, the valve allows flow from ② to ①, while blocking flow at ③. When energized, the cartridge's spool shifts to allow flow from ① to ③, while blocking flow at ②.

失电时，②和①通，与③不通；

得电时，①和③通，与②不通；

手控应急 Operation of Manual Override Option:

To override, push button in, twist counterclockwise 180° and release.

In this position, valve will remain detented in the shifted condition.

To return to normal operation, push button in, twist clockwise 180° and release. Override will be detented in this position.

先推进按钮，再逆时针方向旋转180°，后松开，①和③通，与②不通；

推进按钮，然后顺时针方向旋转180°，后松开，返回到常态；

SYMBOL 机能符号

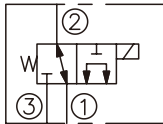

FEATURES

特性

- Continuous-duty solenoid. · 可持续工作的电磁铁。
- Efficient wet-armature construction. · 高效能电磁铁结构。
- Hardened poppet and plunger for long life. · 长寿命的阀。
- Industry common cavity. · 工业通用插孔。
- Compact size. · 紧凑结构。

PRESSURE DROP VS.FLOW

性能图

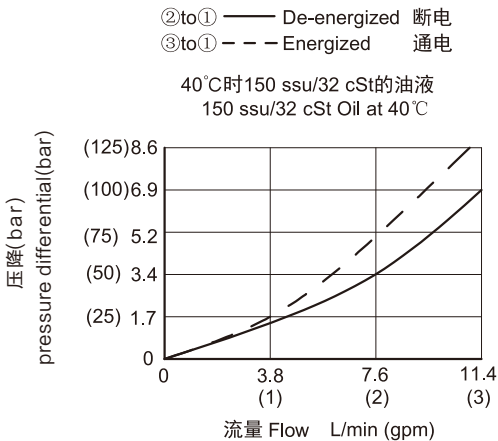

SPECIFICATIONS

技术参数

最大工作压力 Max.operating pressure(Bar): 207

流量 Flow rate(L/min): 参见性能图 See Pressure Drop Vs.Flow graph

内泄漏 Internal Leakage: 82ml/min max. at 207bar

介质温度范围(°C)Fluid temperature range(°C): -30 °C to +120°C

线圈电压范围 Coil Rating: 90%~110% Of rated Voltage

过滤 Filtration:

Critical Application - ISO 18/16/13

Non-Critical Application - ISO 19/17/14

介质 Fluids: 矿物油。其它流体的选择请咨询工厂。

Mineral-based fluids.

For other fluid compatibility consult factory.

插孔 Cavity: 08-3

阀块材料 Body Material:

6061-T6铝，允许使用最大压力207bar

钢材允许使用最大压力350bar

Anodized 6061-T6 aluminum alloy rated at 207bar

Steel rated at 350bar

INSTALLATION DIMENSIONS 安装尺寸

Coil Must Be Installed With Lettering Up
安装线圈时，字母必须朝上。

Unit=Millimeters

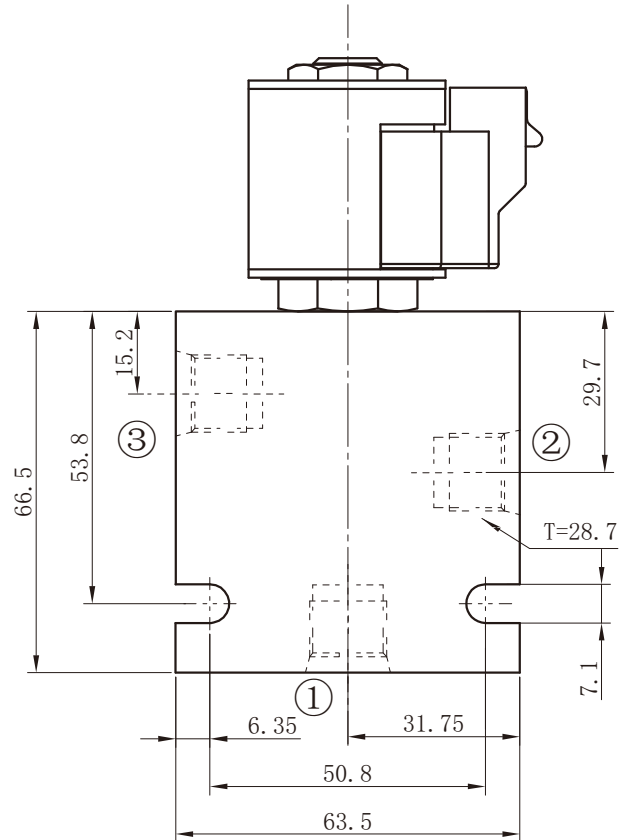
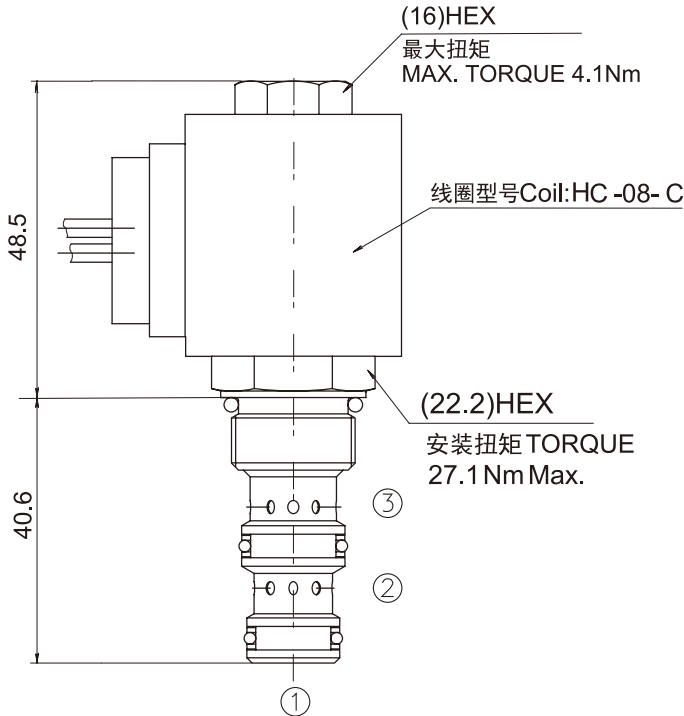

HSV08-31- * - * - * - * - * - *									
电磁阀 Solenoid Valve								BODY PORTING 阀块油口	
S=Screen 过滤网 Omit for standard 省略为常规								6T=SAE6 8T=SAE8 3G=G3/8 4G=G1/2	
M=Manual Override 手动卸荷 Omit for standard 省略为常规								Other Porting is Available 其它螺纹油口也是可以选择的 (Omit for Cartridge only 省略为不带阀块)	
油封 Seal Kits 无 = 丁晴橡胶 (标准型) Omit for Buna N (standard)								COIL CONNECTION 线圈连接	
VOLTAGE 电压 1=12V Volt DC 2=24V Volt DC 3=110V Volt AC 4=220V Volt AC								D=Double Lead 双线 H=Hirschmann 三插 ER=Deutsch Connector (Water proof Coil) 德意志插座 (防水线圈)	